

## Gear Replacement Set

N99-B10-2632-49

### GENECON<sup>12</sup> Gear Replacement Instructions

#### Components

- Large gear x 1
- Intermediate gear x 10
- Set screw x 5
- Axis x 3
- Hex key x 1

#### Required tools

- Phillips-head screwdriver (small)
- Flat-blade screwdriver (small)

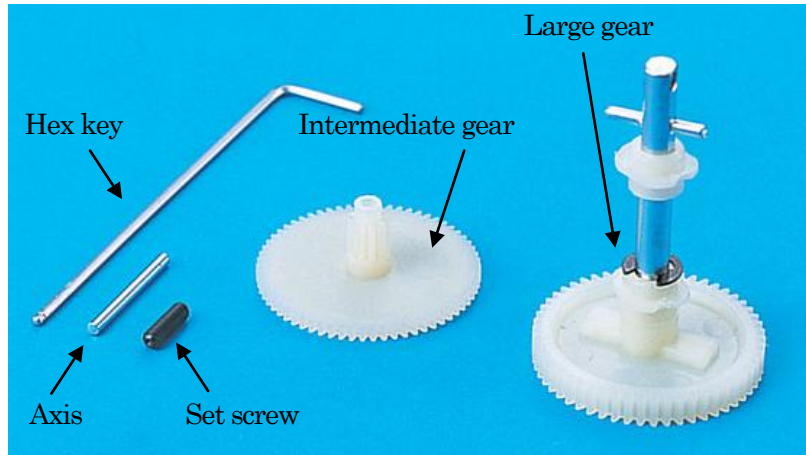

#### Disassembly of the Genecon<sup>12</sup>

##### 1. Remove the cap on the side socket

Insert a flat-blade screwdriver into the depression below the cap to easily remove the cap.

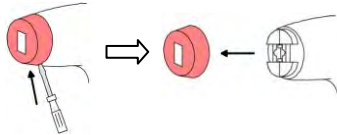

##### 2. Remove the set screw on the handle side.

To remove the set screw, insert the provided hex key into the base of the handle and turn counterclockwise.

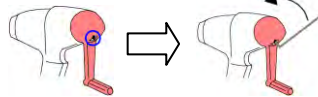

##### 3. Remove the Handle

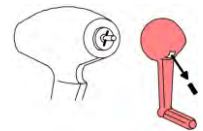

##### 4. Remove the screws.

(Using the Phillips-head screwdriver)  
\* Tear off this sticker in advance.

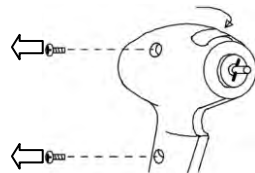

##### 5. Open the main body unit.

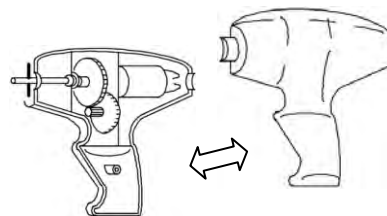

#### Replacing the gears of the Genecon<sup>12</sup>

##### Replacing the intermediate gear

- Insert an axis into the intermediate gear, which is part of the repair gear set.
- Replace the intermediate gear in the main body unit with the ones shown and install them.

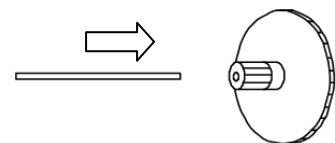

##### Replacing the large gear

- Remove the old large gear from the main body unit and install the new large gear.
  - ✓ **NOTE:** When installing the new gear, be sure to fit it snugly into the main body unit as shown in the illustration below.

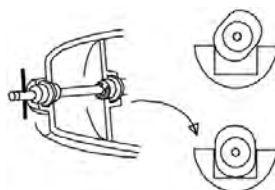

\* Ensure proper fit

To assemble the GENECON<sup>12</sup> simply follow the Disassembly steps in reverse order.